

Infection Connection

"The Intent is to Prevent"

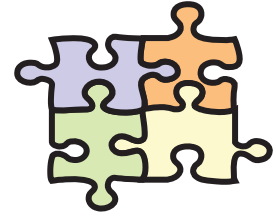

April 2011

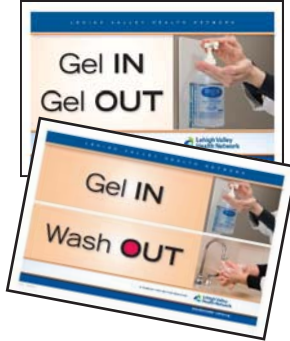

Gel IN/Gel OUT Hand Hygiene Campaign

Listed below is a link to the hand hygiene powerpoint that was shown at the Leader to Leader Meeting. You are encouraged to share the presentation and video with your staff. Please click <http://lvhwebcontent.lvh.com/?id=2645&sid=1> to view.

Recently, newly branded Gel IN/Gel OUT and Gel IN/Wash OUT signage was distributed. If you need additional signs, please contact the Infection Control and Prevention Department at 402-0680. The signs should be placed wherever they are clearly visible and next to the waterless hand sanitizers. In patient care areas they should be placed on all doors. There will also be magnets available to place on the doorways if the patient is on isolation. Each department may modify their location of the signs to best meet their needs.

One and Only Campaign

Gentle reminder that a national patient safety initiative was launched to protect our patients from contamination of used needles or IV fluids. An eLearning course was developed and is required for all those who provide care to our patients. One needle, one syringe, one time. The eLearning course name is "One and Only Campaign" and the course number is "CS1ONLYC11". Please also take a few moments to view the campaign video - <http://www.oneandonlycampaign.org/>.

Personal Protective Equipment (PPE)

It is an OSHA requirement that employees wear PPE (gowns, gloves, masks and eyewear) in the event that exposure to blood and body fluids is anticipated.



It is ALSO a requirement that the PPE is removed at the point in which it was used after the task is completed. The wearing of PPE throughout the institution is prohibited. This provides unwarranted exposure of contaminated PPE to patients, visitors and/or coworkers. PPE should NOT be substituted as a jacket for warmth.

Gloves for Using Disinfectant Wipes

A reminder, gloves should be worn whenever the aseptic-wipes or chlorox wipes are utilized for environmental cleaning. This reduces the potential for skin irritation.

Exchanging Aseptic Wipes with Bleach Wipes for Patients with CDIF

Containers of Aseptic Wipes must be switched out and replaced with Bleach Wipes for patients suspected or identified with CDIF. What to do with the "displaced" container has been brought to our attention. Containers should not be placed in the patient's bathroom, on their bedside stand or on the over the bed tray. Opened containers that have been replaced with Bleach Wipes (or Bleach Wipes that are replaced with Aseptic Wipes after patient discharge) can be wiped off and taken to the soiled utility room for storage and reuse when needed.

Disinfectant Wipe Stickers

We have been made aware that some patients or families have inadvertently mistaken the disinfectant wipes for personal hygiene wipes. Therefore we are in the process of designing warning stickers that will be distributed and should be affixed to all the disinfectant wipe containers. The stickers will say **"Stop, Wipes for Environmental Cleaning ONLY"**. Once they are available a notice will be sent.