

CheckUp Extra!

Site & Facilities

February 17, 1995

CheckUp Extra is a publication that focuses on site and facilities changes at Lehigh Valley Hospital. To provide hospital personnel with timely information about the renovation and relocation of various services, and the employees affected by those changes, CheckUp Extra will appear as a supplement in the regular CheckUp newsletter and as a separate publication on alternate weeks.

Cedar Crest & I-78

Work Continues On GI Lab; Walls Close In On Lobby

As construction of the new GI Lab continues, in the area previously occupied by administrative services, the project is having a dramatic effect on the look and layout of the main lobby.

The lobby is now about half of its original size.

Last December, a temporary wall was erected, 12 feet in front of the existing west wall, to facilitate the construction of the lab.

Now, contractors have shifted the temporary wall 14 feet forward (illustrated below) to allow for the

replacement of large ductwork for the GI Lab and the partial installation of a new stone floor for the lobby. (Please note that the demolition of the existing floor is expected to be noisy.)

In the process, a hallway-of-sorts has been created to allow access to Admissions. The wall does not limit access to the elevators, stairwell 4 or to the Anderson Wing. However, it has slightly reduced the lobby's seating capacity.

The construction of the GI Lab, with a capacity for up to six treatment rooms, will continue through early April.

As work proceeds on the GI Lab, renovations of the main lobby will begin. Tentatively scheduled for April the project will be completed in phases to allow uninterrupted access to admissions and other areas of the hospital. As a result, the lobby will, at times, resemble a series of tunnels. However, this was considered a more practical alternative to re-routing patients and visitors to other hospital entrances. The end-result will be a bright, airy and modern lobby featuring comfortable new furnishings and other attractive decor.

Demolition Of 7A Begins

The demolition of approximately 75 percent of 7A, the former Short Procedure Unit, is now under way. The unit will subsequently be fitted-out and occupied by the nephrology unit now in operation on 7C. Following the relocation of the nephrology unit to 7A, the med-surg unit on 4B will relocate to 7C. In turn, 4B will be converted into the new Pediatric Unit. Room by room evaluation of the pediatric unit's needs will continue through February. Drawings will be available for review in March for final layout approval.

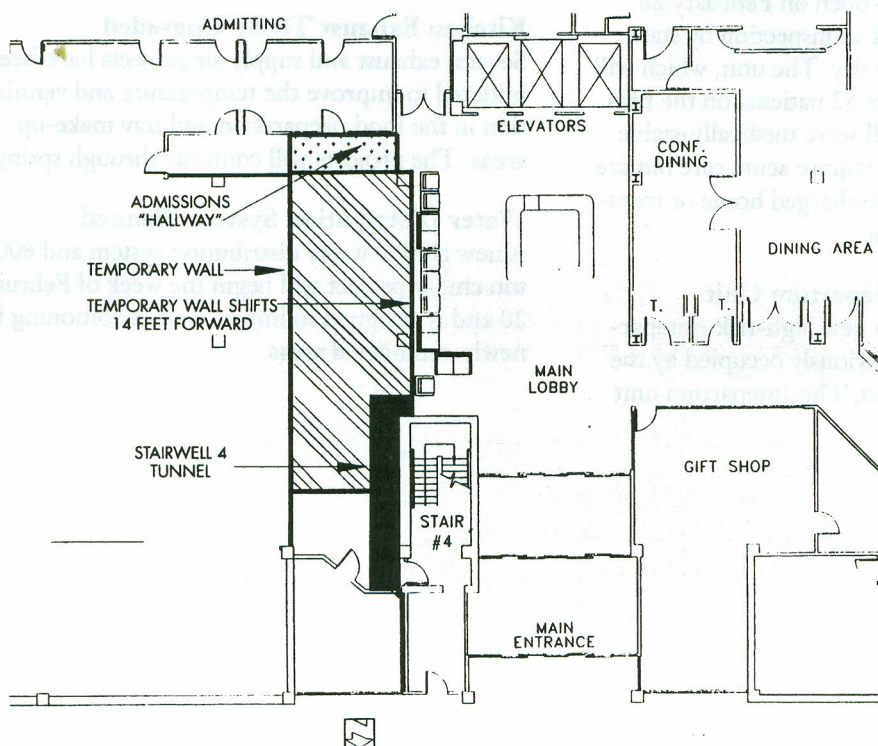

CheckUp Extra!

Site & Facilities

February 17, 1995

Sub-surface Studies Planned

To evaluate ground conditions for prospective building projects, contractors will be drilling at various locations on the hospital campus. Drilling is planned for the areas surrounding the emergency department parking lot, helipad, medical office building 1, MRI, the physician parking lot and main hospital entrance and driveway. The project is likely to begin in late February, weather permitting.

PennDot Inspects Traffic Signals, Patterns

The Pennsylvania Department of Transportation has inspected and approved new traffic signals and

patterns along Cedar Crest Boulevard and the hospital's main access road. The changes result from an extensive road construction project initiated by the hospital to ease the flow of traffic inside and adjacent to the hospital campus. Please remember that there are two left-turn outbound lanes.

Cafeteria Upgrades Planned

A series of minor projects to enhance cafeteria and food service functions are nearing completion. To avoid disruptions in service, the projects have been scheduled during evening hours. Exhaust changes in the kitchen will continue through mid-summer.

17th & Chew

Skilled Unit To Open Soon

The Lehigh Valley Skilled Transitional Unit is tentatively scheduled to open on February 28 pending the outcome of an inspection by state officials on the previous day. The unit, which will eventually accommodate 52 patients on the fifth floor of the hospital, will serve medically-stable patients who no longer require acute care but are not well enough to be discharged home or transferred to a nursing home.

Work Begins On Antepartum Unit

Work is under way on a new high-risk Antepartum Unit in the area previously occupied by the Labor and Delivery Unit. The antepartum unit

will serve women who require hospitalization during pregnancy.

Kitchen Exhaust To Be Upgraded

Several exhaust and supply air projects have been initiated to improve the temperature and ventilation in the food preparation and tray make-up areas. The projects will continue through spring.

Water Distribution System Planned

A new chilled water distribution system and 800 ton chiller project will begin the week of February 20 and is designed to improve air conditioning for newly-remodeled areas.